

K-Nr.: 30777/04 Stromkompensierte Drossel / Common Mode Choke 24.09.2025
K-no.:

Kunde: Standardreihe Kd. Sach Nr.: Seite 1 von 4
Customer Customers part no.: Page of

- Designentwurf ohne Muster • Vorläufiges Datenblatt / Draft version without sample • Specification not finalized
- Entwicklungsmuster • Vorläufiges Datenblatt / Development sample • Specification not finalized
- Muster für Designfreigabe • Endgültiges Datenblatt / Sample for Design release • Final specification
- Erstmuster zur Produktionsfreigabe / First articles for Production release

Anmerkungen zum Musterstatus / Further remarks on sample status

Funktionsmuster VACOCOIL® 3Phase

- Mechanical dimensions not final -> drawing according samples and series design
- SLS-Casings: Limited thermal test -> in series PA66 GF35
- LLeak, Rcu, lunbal, m adjusted according sample measurements

Typische 3D Darstellung
typical 3D-illustration

Drawing/Mechanical Outline see page 2

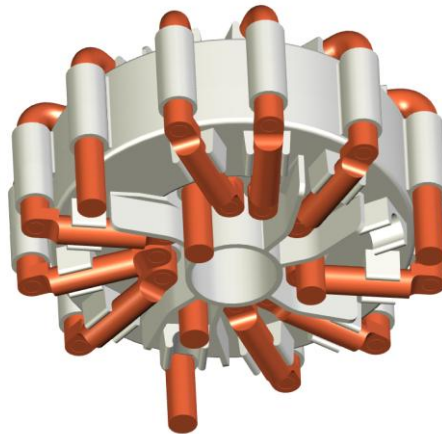
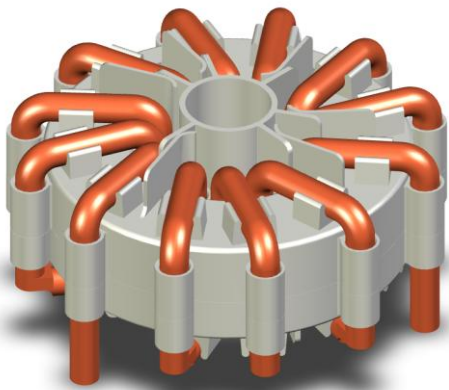

Anschlußschema:
Schematic diagram

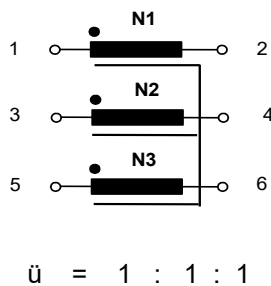

Betriebsdaten/Charakteristische Daten (Typische Werte):
Operational data/characteristic data (typical values):

	f=10kHz	f=100kHz	DC	
L [mH]	1.21	0.77		*Preliminary
Z [Ω]	76	590		
I _{unbal.} [A]	0.6	1.0	0.6 (70% L _o @10kHz)	

L_s / L_{leak} ≈ 1.7 μH and f = 100 kHz (Eine benachbarte Wicklung kurzgeschlossen / one adjacent winding shorted)

Bemessungsisolationsspannung / rated insulation voltage:

U_{is} = 1000 V_{RMS} (1414 V_{peak}) (Netzstromkreis / connected to the mains)
1500 V_{RMS} (2121 V_{peak}) (Nicht-Netzstromkreis / not connected to the mains)

I_N = 3 × 120 A m ≈ 660g

Max. Betriebstemperatur / max.operating temperature T_{op} = +130°C

Umgebungstemperatur / ambient temperature: T_a = -40°C...+75°C

Lagertemperatur / storage temperature: T_{st} = -40°C...+85°C

Kundenfreigabe: Datenblatt geprüft und freigegeben / Specification checked and released
customer release: Muster geprüft / samples tested

Date: _____
Name / Department _____

Datum	Name	Index	Änderung

Hrsg.: KB-E Bearb: Saw KB-PM: freig.:
editor designer check

K-Nr.: 30777/04
K-no.:

Stromkompensierte Drossel / Common Mode Choke

24.09.2025

Kunde: Standardreihe
Customer

Kd. Sach Nr.:
Customers part no.:

Seite 2 von 4
Page of

Maßbild (mm): Freimaßtoleranz DIN ISO 2768-c
Mechanical outline General tolerances

Beschriftung:
marking

VAC
K30777/04
F DC

Anschlüsse:
Connections:

Cu unverzinkt
Cu blank
Ø = 6 mm

F = Factory
DC = Date code

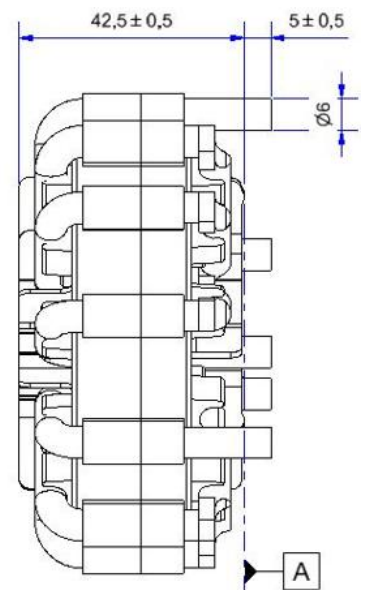
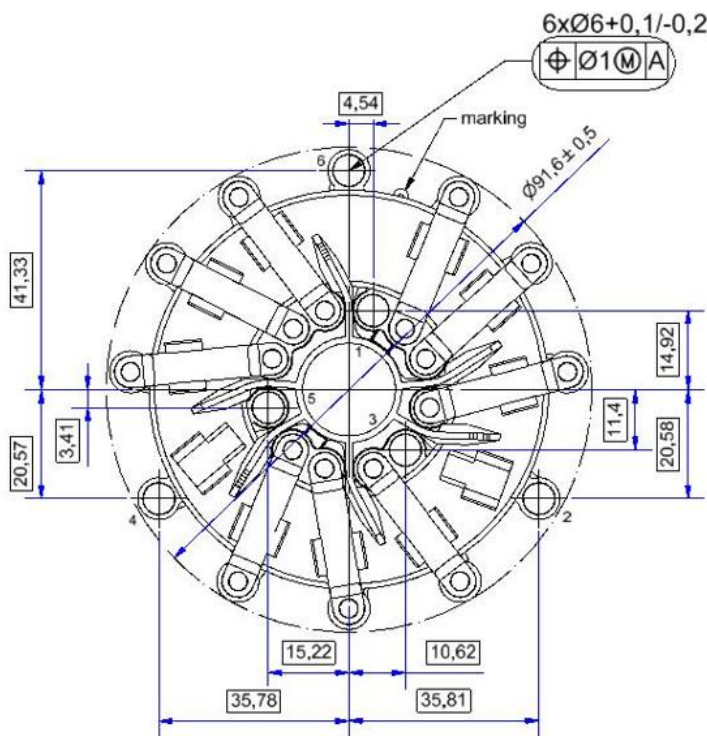

Preliminary
Draft

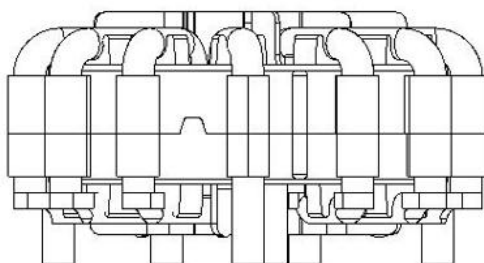

DC=Date Code
F=Factory

○ = test dimension

3-fach

Hrsg.: KB-E
editor

Bearb: Saw
designer

KB-PM:
check

freig.: ~~released~~

K-Nr.: 30777/04
K-no.:

Stromkompensierte Drossel / Common Mode Choke

24.09.2025

Kunde: Standardreihe
Customer

Kd. Sach Nr.:
Customers part no.:

Seite 4 von 4
Page of

Typische Kurven / typical characteristics :

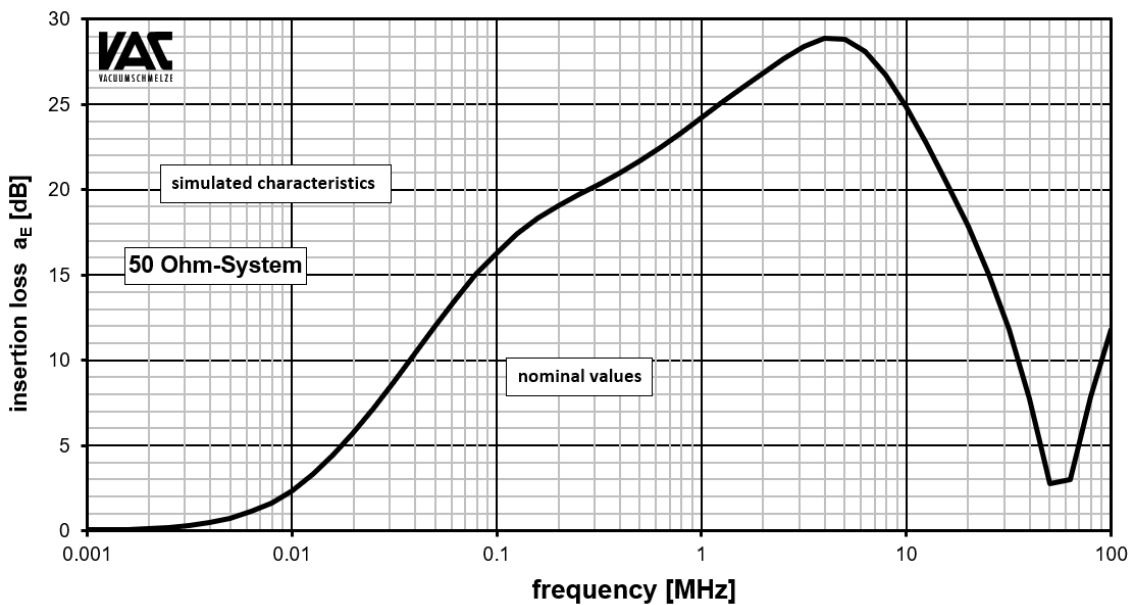
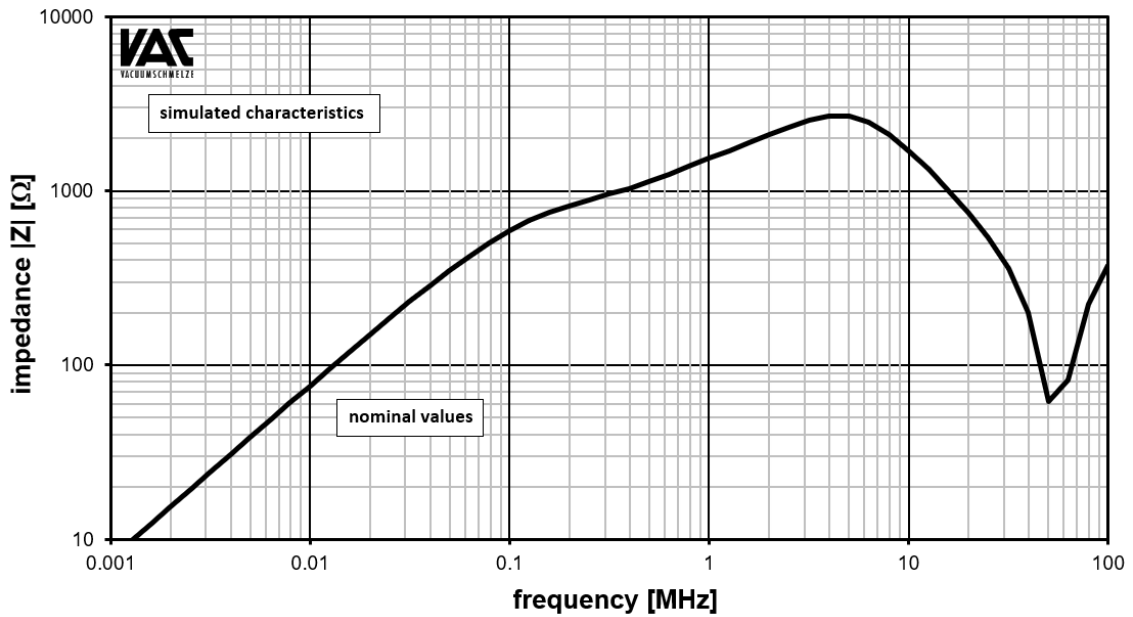

Bemerkung:
Remark:

Blankdraht anstatt Lackdraht verwendet.
Uncoated wire instead of enameled wire used.

Hrsg.: KB-E
editor

Bearb: Saw
designer

KB-PM:
check

freig.: ~~released~~